

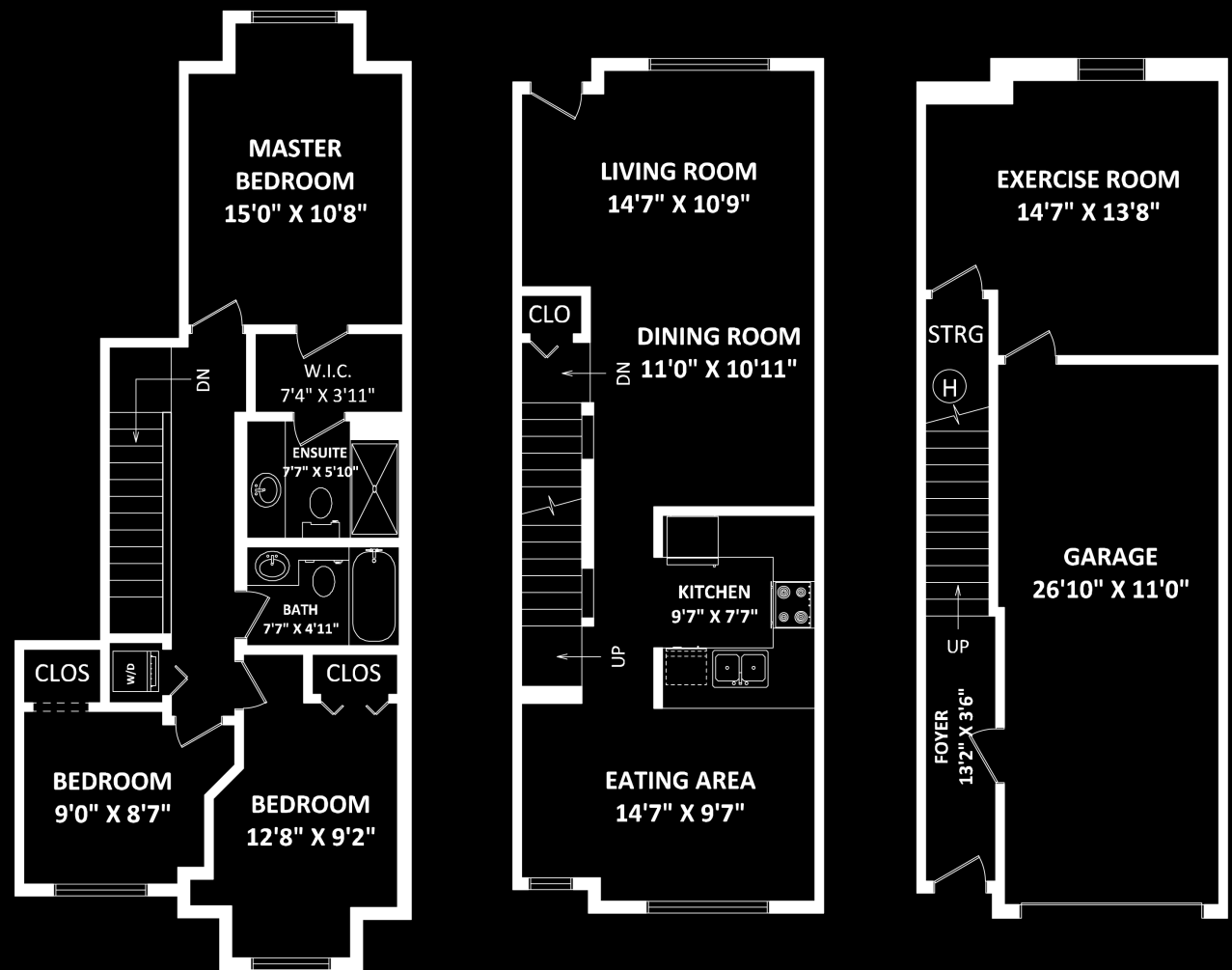

Get The Price & MLS® On Your Phone!
 Get our FREE APP sent directly to your smartphone.
 To: **65656** Msg: **4SALE2**

Welcome To

#146 18701 66th Ave, Cloverdale



UPPER FLOOR: 675 SQ.FT. MAIN FLOOR: 635 SQ.FT. LOWER FLOOR: 58 SQ.FT.
 EXERCISE ROOM: 209 SQ.FT.

TOTAL FINISHED AREA: 1577 SQ.FT.
 MAIN LIVING AREA: 1368 SQ.FT.
 EXERCISE ROOM: 209 SQ.FT.

OTHER AREA(S)
 GARAGE: 367 SQ.FT.

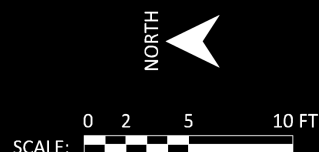

This version of the floorplan is for marketing purposes only.
 Please contact Bettina Reid for specifications: 778-998-9645

This communication is not intended to cause or induce breach of an existing agency agreement.



The Bettina Reid Group
 building relationships for life



#146 18701 66th Ave, Cloverdale

Encore at Hillcrest, Convenience is yours, only steps to Save-On, Tim Horton's, Doctors office with walk-in clinic, Dentists, Banking institutions, restaurants and so much more! This 3 bedroom, 2 bathroom unit has laminate floors on the main, tile flooring in all the bathrooms and kitchen. Kitchen has Stainless Steel appliances, eat up bar and pot rack for extra storage space. Master has double wide shower in the ensuite and large walk-in closet. Walk out to fenced backyard off of the living room, gate leads to courtyard with mini parkette for little ones to play in. Within walking distance to both sought after Hillcrest Elementary and Clayton Secondary Schools. Do not miss out!



Up-to-Date Price	To: 65656 Msg: 4SALE2
Strata Fees	\$214.69
Parking	2
Size	1577 ft ²
Age	9 years
Style	3 Storey
Bedrooms	3
Bathrooms	2



For more photos and a virtual tour, please visit: www.bettinareidgroup.ca



The Bettina Reid Group 778-998-9645
 Homelife Benchmark Realty Cloverdale
 #103 5830 176A St, Surrey BC V3S 4H5